

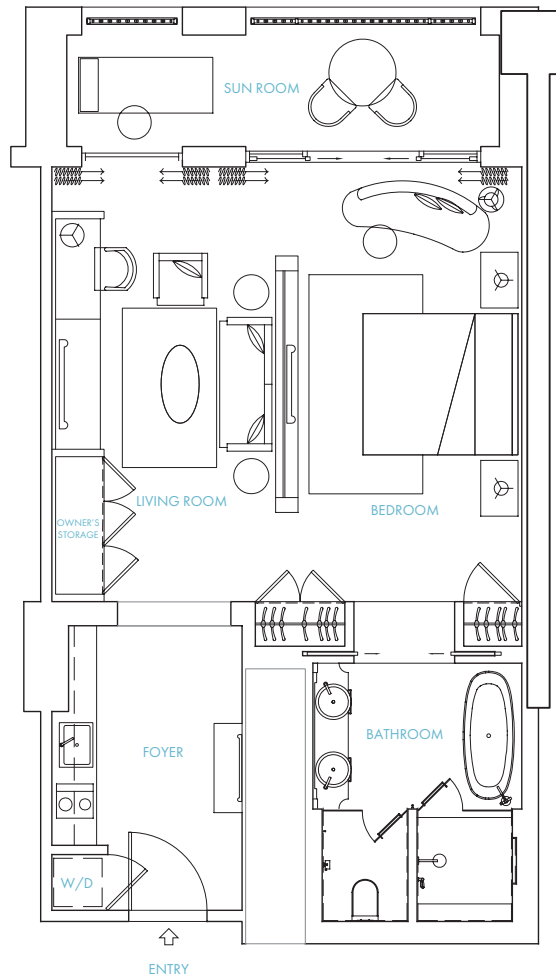

ROSEWOOD
BAHA MAR

One-Bedroom Residence Studio

INTERIOR 653-719 SQ FT | EXTERIOR 117-213 SQ FT
TOTAL 752-932 SQ FT



BAHA MAR
RESIDENCES

NASSAU, THE BAHAMAS

RESIDENCES@BAHAMAR.COM

Unit Floor Plans are dimensioned but not to scale. Square footage is approximate and constitutes an estimate only. Square footage can vary and is subject to differing measuring techniques. Units are being sold based upon the Unit and its location without any guaranty of actual square footage. Furnishings and their layout may not be representative of actual Unit furnishings. This is not an offering in any jurisdiction where prohibited by law and materials will not be forwarded into such jurisdictions unless the Developer has complied with the requirements of such jurisdiction. CTF BM Operations, Ltd uses the Rosewood™ and the SLS™ brand names and certain trademarks (collectively, the "Trademarks") in connection with the sales and marketing of the Residential Units in Baha Mar under limited, non-exclusive, non-transferable and non-sublicensable licenses. The foregoing licenses may be terminated or may expire without renewal, in which the Residential Units and any part of Baha Mar will be branded, identified or affiliated with any of the Trademarks or have any rights to use the Trademarks. Rosewood Hotels and Resorts, LLC ("Rosewood"), SBE Hotel Management, LLC ("SBE" or "SLS") or any of their affiliates (collectively, the "Brands") do not have any responsibility for the development, offering, marketing, sale or solicitation of the Residential Units at Baha Mar, the contents of any governing documents and any offering and sales documents (including, without limitation, the budgets therein), or the sales and marketing process (including, without limitation, any sales or marketing materials and any statements or representations by Developer, brokers or sales persons).

Copyright © 2019 – CTF BM Operations, Ltd. – All Rights Reserved.





ROSEWOOD

BAHA MAR

Two-Bedroom Residence

INTERIOR 1358-1407 SQ FT | EXTERIOR 224-476 SQ FT
TOTAL 1594-1871 SQ FT

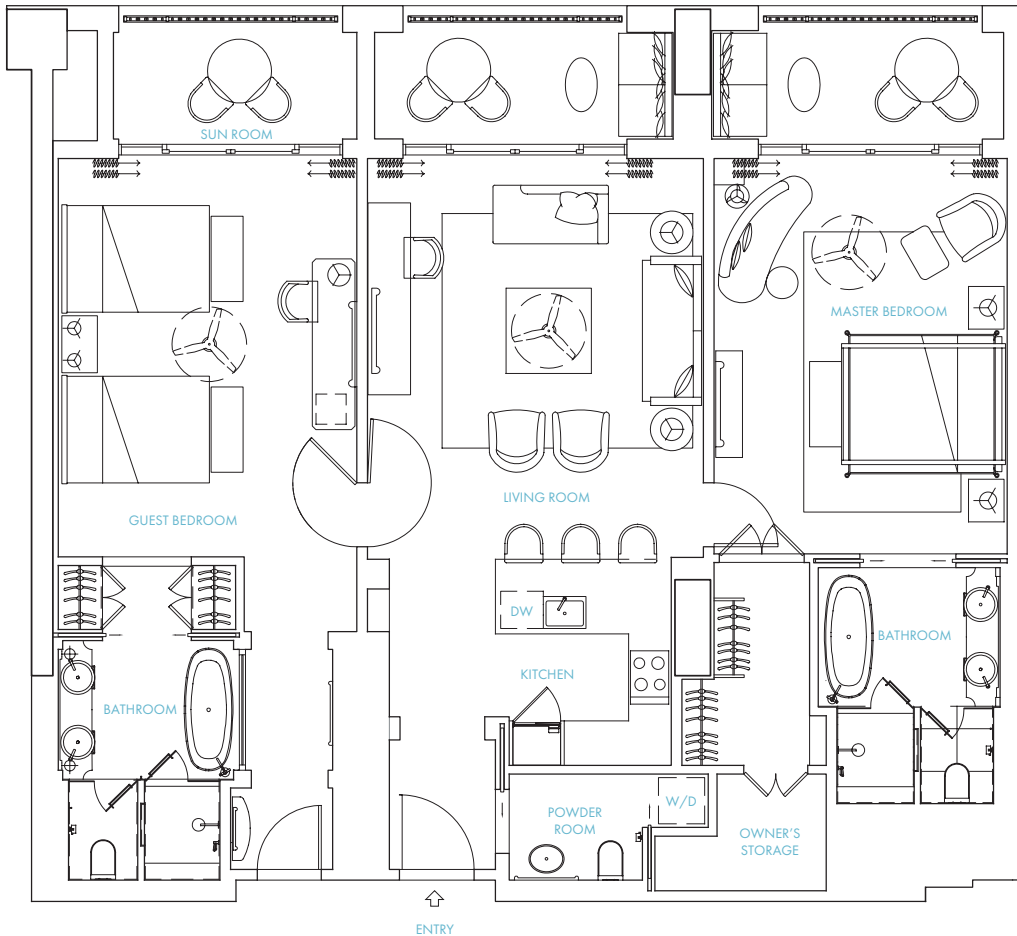

BAHA MAR

RESIDENCES

NASSAU, THE BAHAMAS

RESIDENCES@BAHAMAR.COM

Unit Floor Plans are dimensioned but not to scale. Square footage is approximate and constitutes an estimate only. Square footage can vary and is subject to differing measuring techniques. Units are being sold based upon the Unit and its location without any guaranty of actual square footage. Furnishings and their layout may not be representative of actual Unit furnishings. This is not an offering in any jurisdiction where prohibited by law and materials will not be forwarded into such jurisdictions unless the Developer has complied with the requirements of such jurisdiction. CTF BM Operations, Ltd uses the Rosewood™ and the SLS™ brand names and certain trademarks (collectively, the "Trademarks") in connection with the sales and marketing of the Residential Units in Baha Mar under limited, non-exclusive, non-transferable and non-sublicensable licenses. The foregoing licenses may be terminated or may expire without renewal, in which the Residential Units and any part of Baha Mar will be branded, identified or affiliated with any of the Trademarks or have any rights to use the Trademarks. Rosewood Hotels and Resorts, LLC ("Rosewood"), SBE Hotel Management, LLC ("SBE" or "SLS") or any of their affiliates (collectively, the "Brands") do not have any responsibility for the development, offering, marketing, sale or solicitation of the Residential Units at Baha Mar, the contents of any governing documents and any offering and sales documents (including, without limitation, the budgets therein), or the sales and marketing process (including, without limitation, any sales or marketing materials and any statements or representations by Developer, brokers or sales persons).

Copyright © 2019 – CTF BM Operations, Ltd. – All Rights Reserved.



ROSEWOOD

BAHAMAR

Two-Bedroom Large Residence

INTERIOR 1740-1757 SQ FT | EXTERIOR 328-980 SQ FT
TOTAL 2068-2737 SQ FT

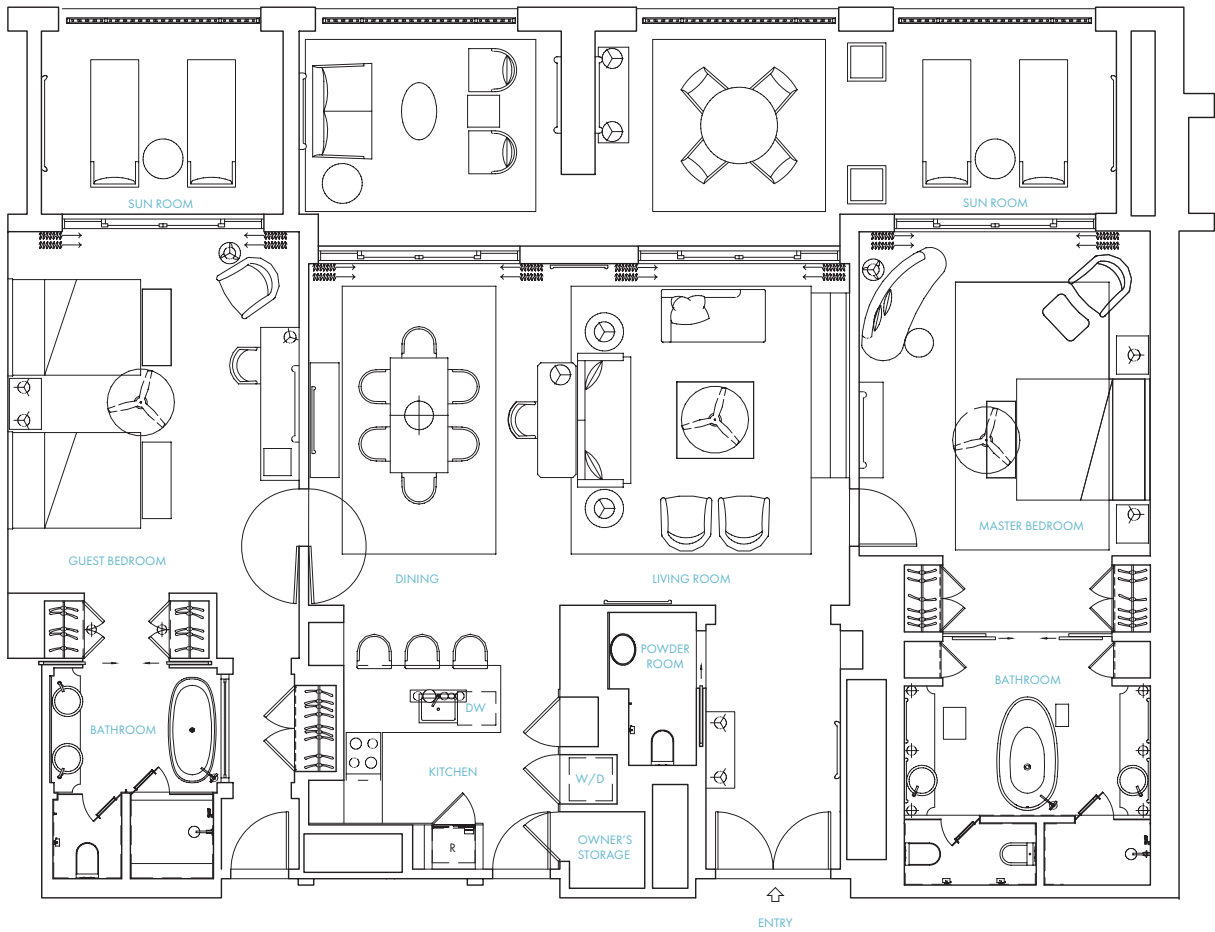

BAHAMAR

RESIDENCES

NASSAU, THE BAHAMAS

RESIDENCES@BAHAMAR.COM

Unit Floor Plans are dimensioned but not to scale. Square footage is approximate and constitutes an estimate only. Square footage can vary and is subject to differing measuring techniques. Units are being sold based upon the Unit and its location without any guaranty of actual square footage. Furnishings and their layout may not be representative of actual Unit furnishings. This is not an offering in any jurisdiction where prohibited by law and materials will not be forwarded into such jurisdictions unless the Developer has complied with the requirements of such jurisdiction. CTF BM Operations, Ltd uses the Rosewood™ and the SLS™ brand names and certain trademarks (collectively, the "Trademarks") in connection with the sales and marketing of the Residential Units in Baha Mar under limited, non-exclusive, non-transferable and non-sublicensable licenses. The foregoing licenses may be terminated or may expire without renewal, in which the Residential Units and any part of Baha Mar will be branded, identified or affiliated with any of the Trademarks or have any rights to use the Trademarks. Rosewood Hotels and Resorts, LLC ("Rosewood"), SBE Hotel Management, LLC ("SBE" or "SLS") or any of their affiliates (collectively, the "Brands") do not have any responsibility for the development, offering, marketing, sale or solicitation of the Residential Units at Baha Mar, the contents of any governing documents and any offering and sales documents (including, without limitation, the budgets therein), or the sales and marketing process (including, without limitation, any sales or marketing materials and any statements or representations by Developer, brokers or sales persons).

Copyright © 2019 - CTF BM Operations, Ltd. - All Rights Reserved.





ROSEWOOD

BAHA MAR

Two-Bedroom Terrace Residence

INTERIOR 1805 SQ FT | EXTERIOR 2368 SQ FT
TOTAL 4173 SQ FT

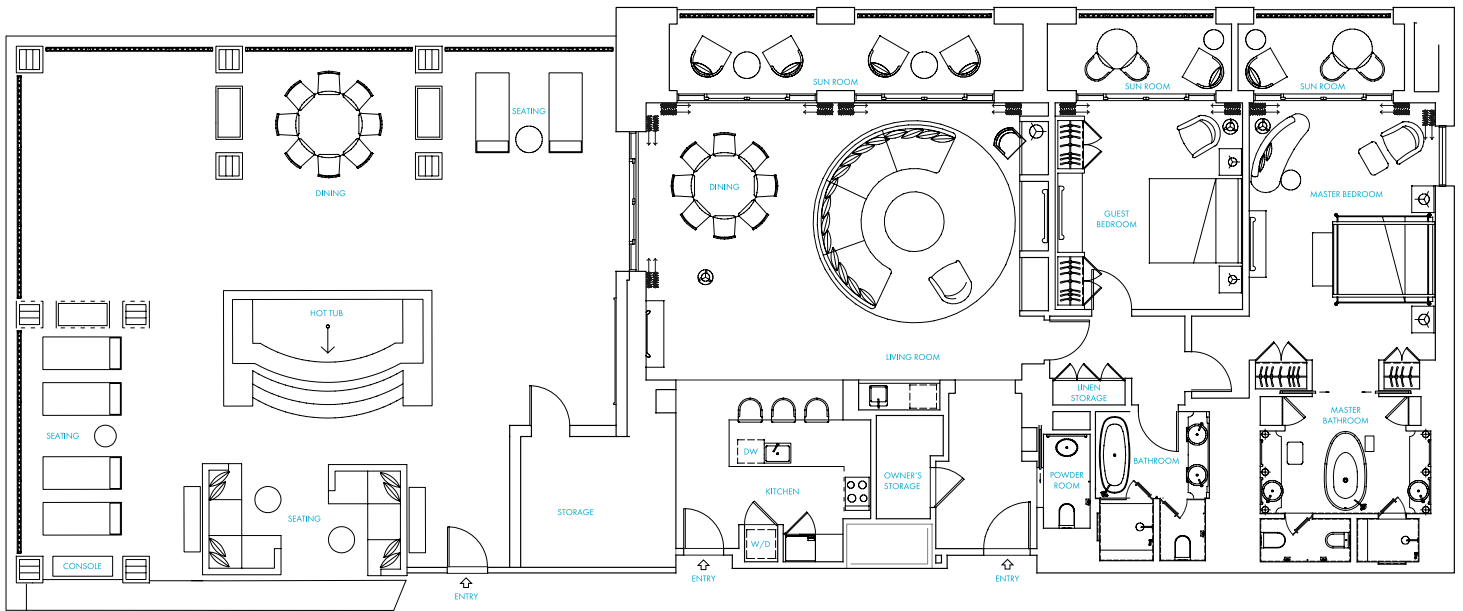

BAHA MAR
RESIDENCES
NASSAU, THE BAHAMAS
RESIDENCES@BAHAMAR.COM

Unit Floor Plans are dimensioned but not to scale. Square footage is approximate and constitutes an estimate only. Square footage can vary and is subject to differing measuring techniques. Units are being sold based upon the Unit and its location without any guaranty of actual square footage. Furnishings and their layout may not be representative of actual Unit furnishings. This is not an offering in any jurisdiction where prohibited by law and materials will not be forwarded into such jurisdictions unless the Developer has complied with the requirements of such jurisdiction. CTF BM Operations, Ltd uses the Rosewood™ and the SLS™ brand names and certain trademarks (collectively, the "Trademarks") in connection with the sales and marketing of the Residential Units in Baha Mar under limited, non-exclusive, non-transferable and non-sublicensable licenses. The foregoing licenses may be terminated or may expire without renewal, in which the Residential Units and any part of Baha Mar will be branded, identified or affiliated with any of the Trademarks or have any rights to use the Trademarks. Rosewood Hotels and Resorts, LLC ("Rosewood"), SBE Hotel Management, LLC ("SBE" or "SLS") or any of their affiliates (collectively, the "Brands") do not have any responsibility for the development, offering, marketing, sale or solicitation of the Residential Units at Baha Mar, the contents of any governing documents and any offering and sales documents (including, without limitation, the budgets therein), or the sales and marketing process (including, without limitation, any sales or marketing materials and any statements or representations by Developer, brokers or sales persons).

Copyright © 2019 – CTF BM Operations, Ltd. – All Rights Reserved.





ROSEWOOD

BAHAMAR

Three-Bedroom Residence

INTERIOR 2333 SQ FT | EXTERIOR 652 SQ FT
TOTAL 2985 SQ FT

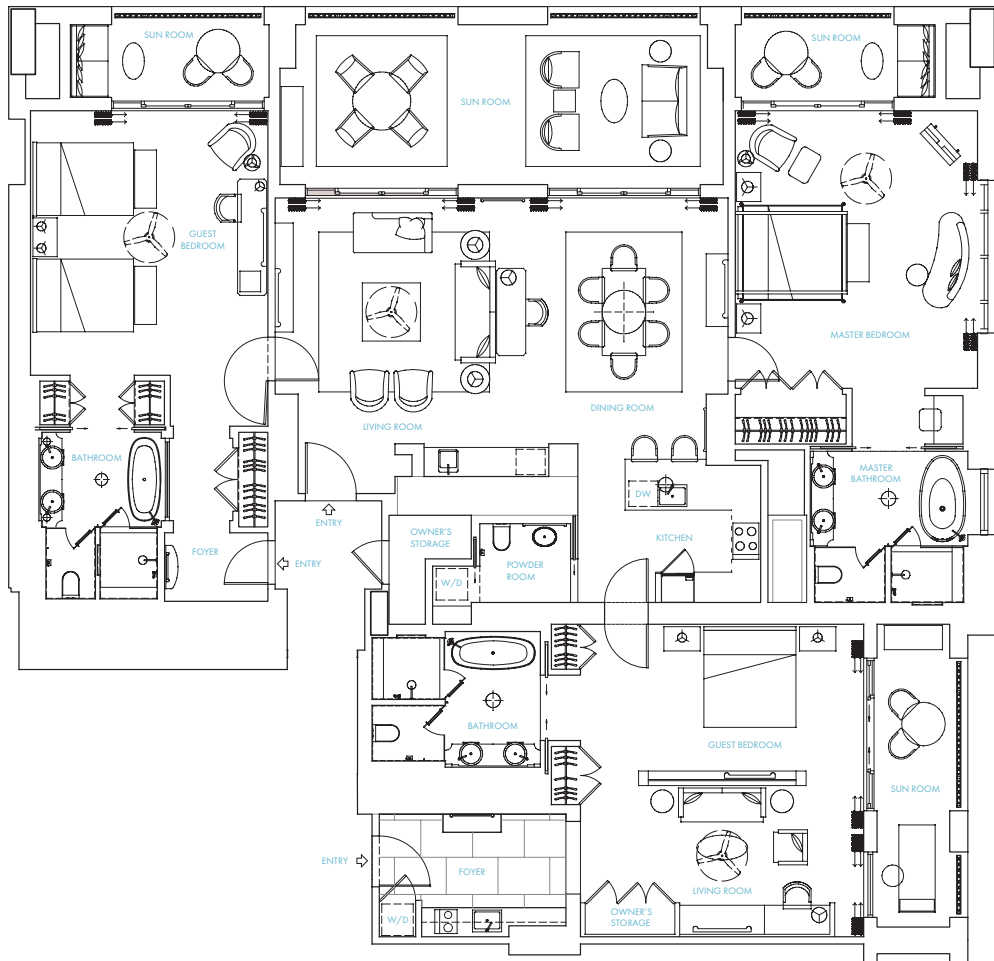

BAHAMAR

RESIDENCES

NASSAU, THE BAHAMAS

RESIDENCES@BAHAMAR.COM

Unit Floor Plans are dimensioned but not to scale. Square footage is approximate and constitutes an estimate only. Square footage can vary and is subject to differing measuring techniques. Units are being sold based upon the Unit and its location without any guaranty of actual square footage. Furnishings and their layout may not be representative of actual Unit furnishings. This is not an offering in any jurisdiction where prohibited by law and materials will not be forwarded into such jurisdictions unless the Developer has complied with the requirements of such jurisdiction. CTF BM Operations, Ltd uses the Rosewood™ and the SLS™ brand names and certain trademarks (collectively, the "Trademarks") in connection with the sales and marketing of the Residential Units in Baha Mar under limited, non-exclusive, non-transferable and non-sublicensable licenses. The foregoing licenses may be terminated or may expire without renewal, in which the Residential Units and any part of Baha Mar will be branded, identified or affiliated with any of the Trademarks or have any rights to use the Trademarks. Rosewood Hotels and Resorts, LLC ("Rosewood"), SBE Hotel Management, LLC ("SBE" or "SLS") or any of their affiliates (collectively, the "Brands") do not have any responsibility for the development, offering, marketing, sale or solicitation of the Residential Units at Baha Mar, the contents of any governing documents and any offering and sales documents (including, without limitation, the budgets therein), or the sales and marketing process (including, without limitation, any sales or marketing materials and any statements or representations by Developer, brokers or sales persons).

Copyright © 2019 – CTF BM Operations, Ltd. – All Rights Reserved.

